

MOD  **STUDIOS**





AN OUTSTANDING OFFICE, LEISURE OR RETAIL OPPORTUNITY AT THE HEART OF THE CITY

A thriving hub of food, drink, art and leisure connected by raised arterial walkways creating a tranquil haven nestled amidst the hustle and bustle of the Capital.

ARAX PROPERTIES

LONDON'S LATEST LIFESTYLE DESTINATION

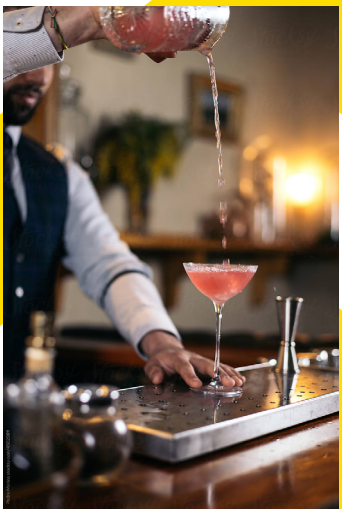



INTRODUCING MODE STUDIOS

- An outstanding Class E opportunity with a high degree of flexibility within a reimagined public concourse.
- Transformed and reimagined public realm in an iconic City location.
- An exciting opportunity suitable for a range of uses, including F&B, art and office, culture and retail.
- Next door to the iconic Barbican Estate and its 6,500 residents as well as an abundant office population.
- New and simplified arrival experience, with unparalleled visibility opportunities from London Wall and Moorgate.

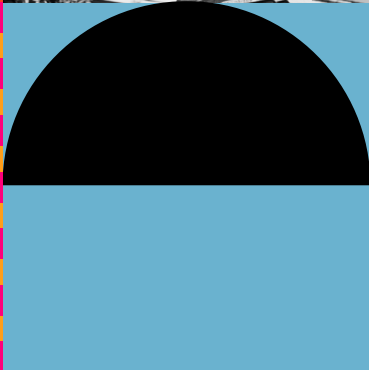
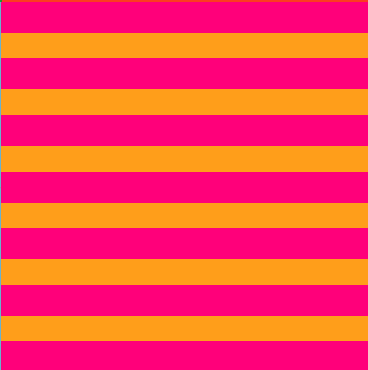
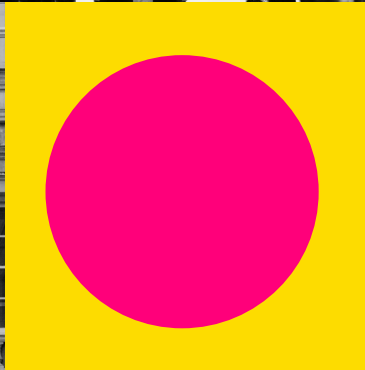
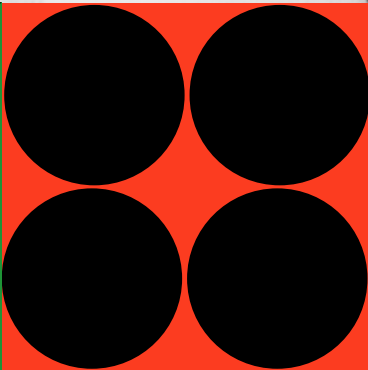
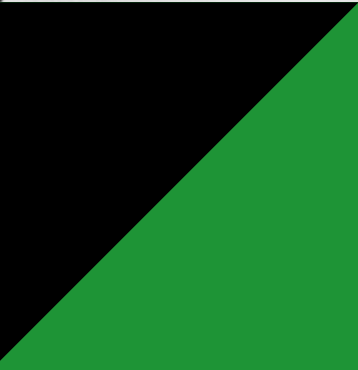
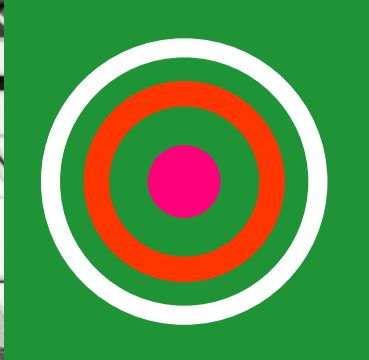

The Area

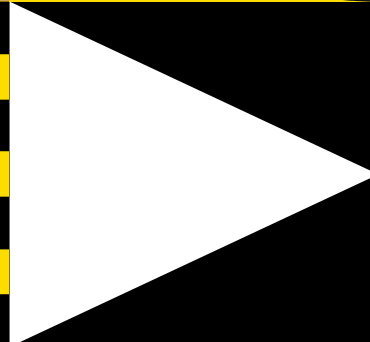

WHERE THE CITY MEETS FARRINGDON



HYPER CONNECTED

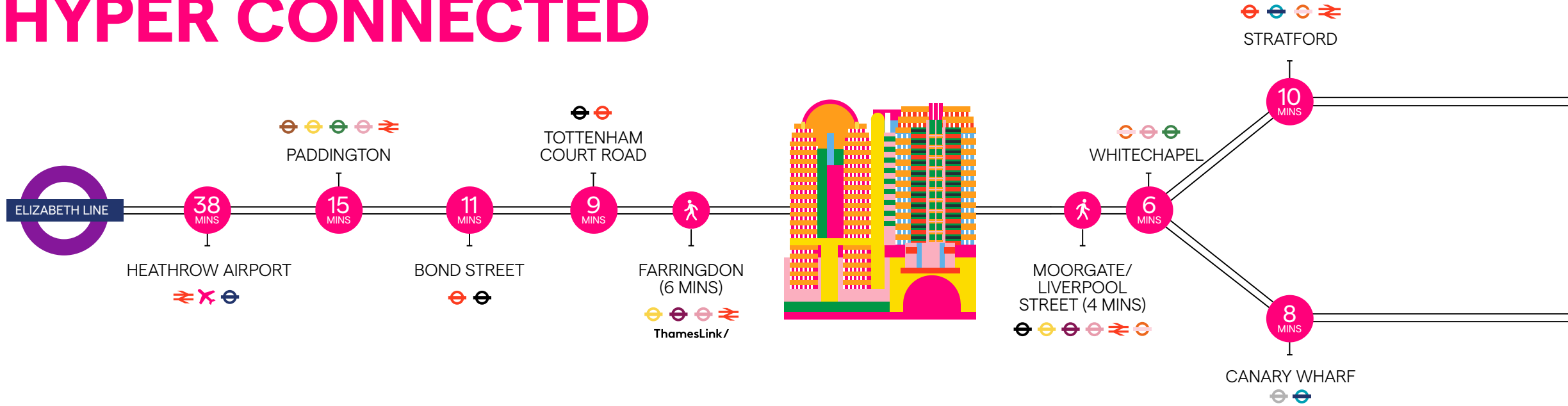

MOORGATE - 4 MIN WALK



ST PAUL'S - 5 MIN WALK



FARRINGDON - 6 MIN WALK



BARBICAN - 6 MIN WALK



- | | |
|--------------|-----------------|
| CENTRAL | BAKERLOO |
| PICCADILLY | WATERLOO & CITY |
| CIRCLE | DLR |
| DISTRICT | OVERGROUND |
| HAMMERSMITH | ELIZABETH |
| JUBILEE | NATIONAL RAIL |
| NORTHERN | AIRPORT EXPRESS |
| METROPOLITAN | THAMESLINK |
| VICTORIA | |

* Door to door travel times taken from TFL and Google

ON YOUR DOORSTEP

Festival Gardens



Barbican



Postman's Park



Broadgate Circle

OLD MEETS NEW

Redemption Roasters



Barbie Green



The Jugged Hare



Rosslyn Coffee

Bow Lane

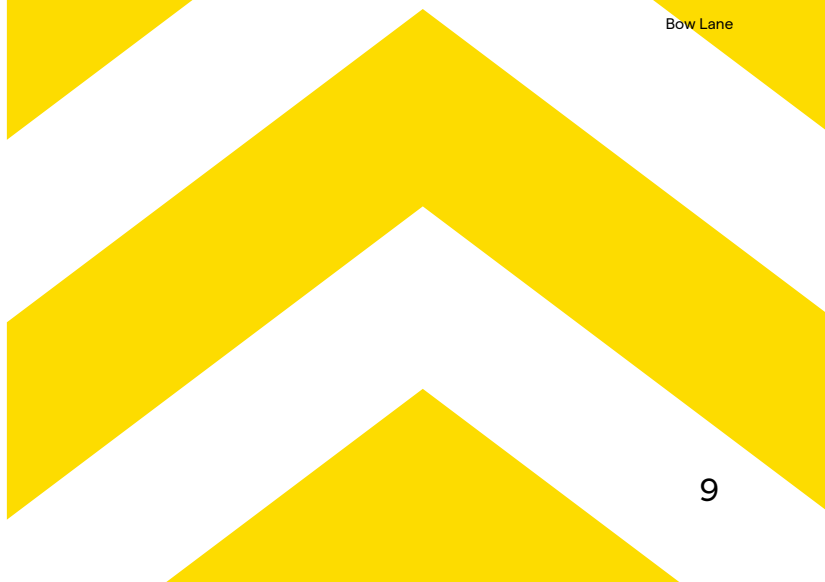

DIVERSE NEIGHBOURS





The Building

AVAILABLE SPACE



INTERACTIVE
STACKER AND
REFERENCE
CALCULATOR

LEVEL	NIA (SQ FT)	GIA (SQ FT)
4	4,016	5,332
3	4,682	5,564
2 (PODIUM LEVEL)	4,154	4,194
1	4,662	5,408
STREET LEVEL	3,927	4,771
TOTAL	21,441 SQ FT	25,269 SQ FT

STREET LEVEL

- MODE Studios Amenity/Leisure
- Mode Enlarged Reception
- Loading Bay
- Podium Outline



 COMMUTER FACILITIES



 FARRINGDON

 5 MINS WALK

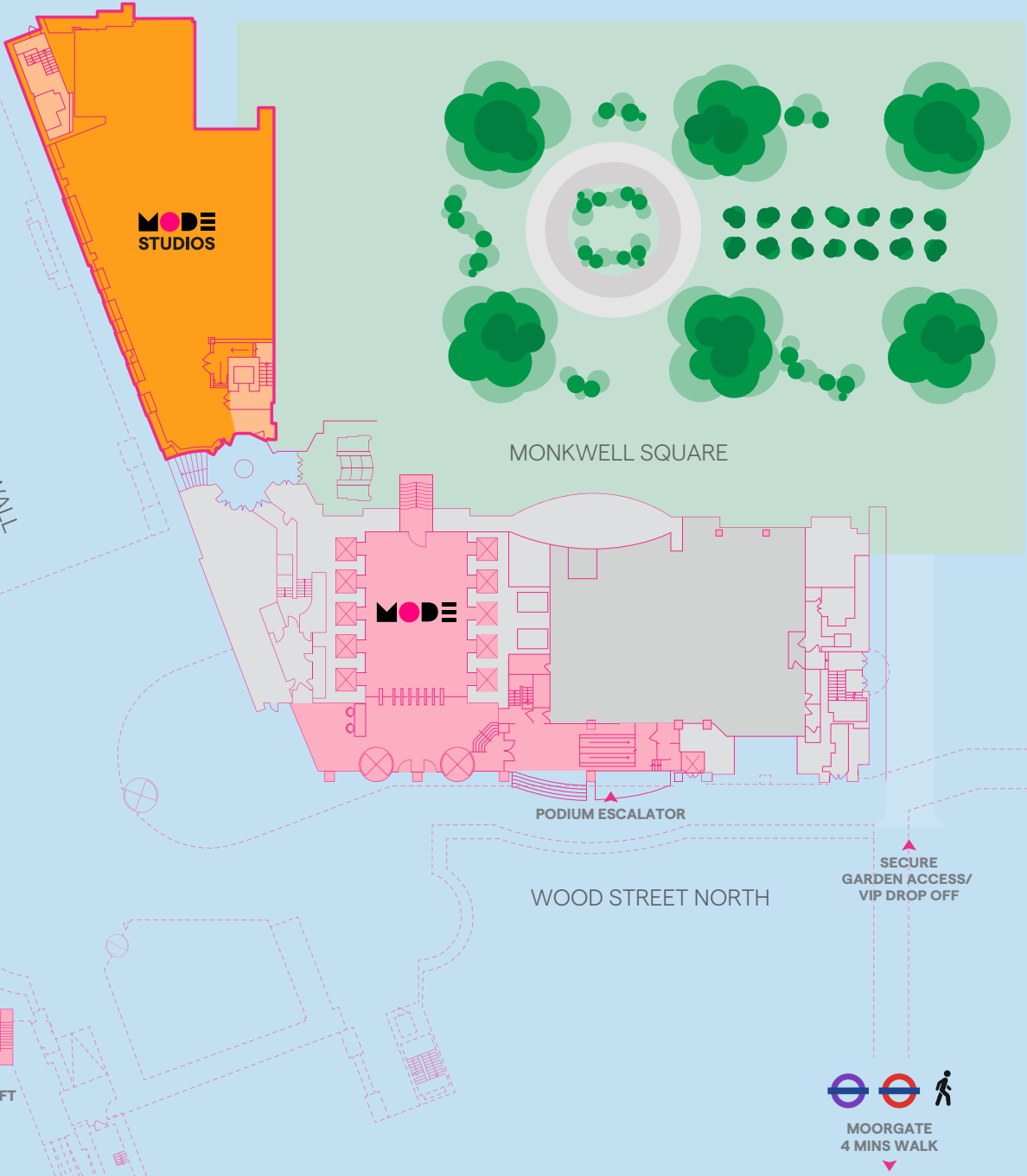

INDICATIVE ONLY, NOT TO SCALE,
SUBJECT TO FINAL DESIGN



STREET LEVEL

NIA
3,927 sq. ft
365 sq. m

GIA
4,771 sq. ft

- Net Internal Area
- Core
- External access

**INDICATIVE ONLY, NOT TO SCALE,
SUBJECT TO FINAL DESIGN**

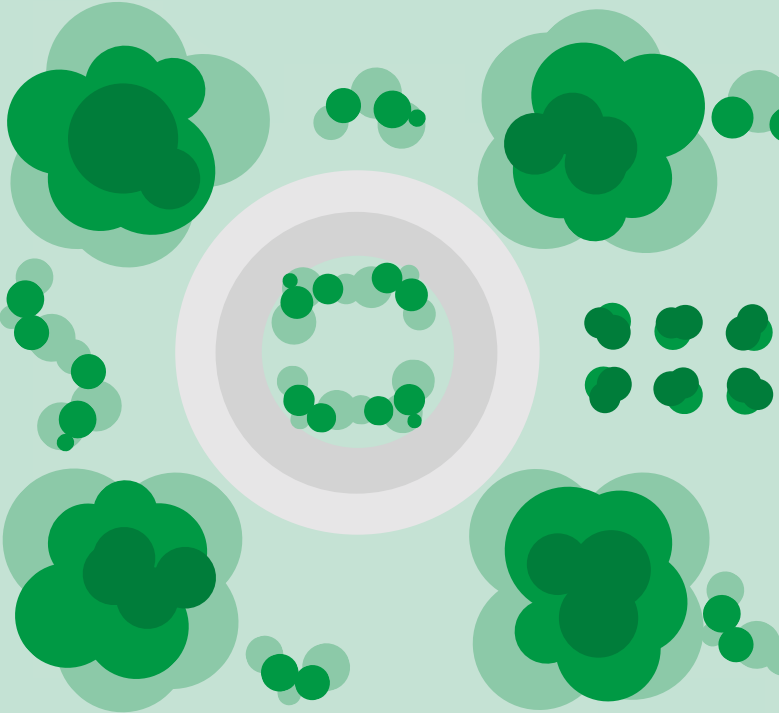
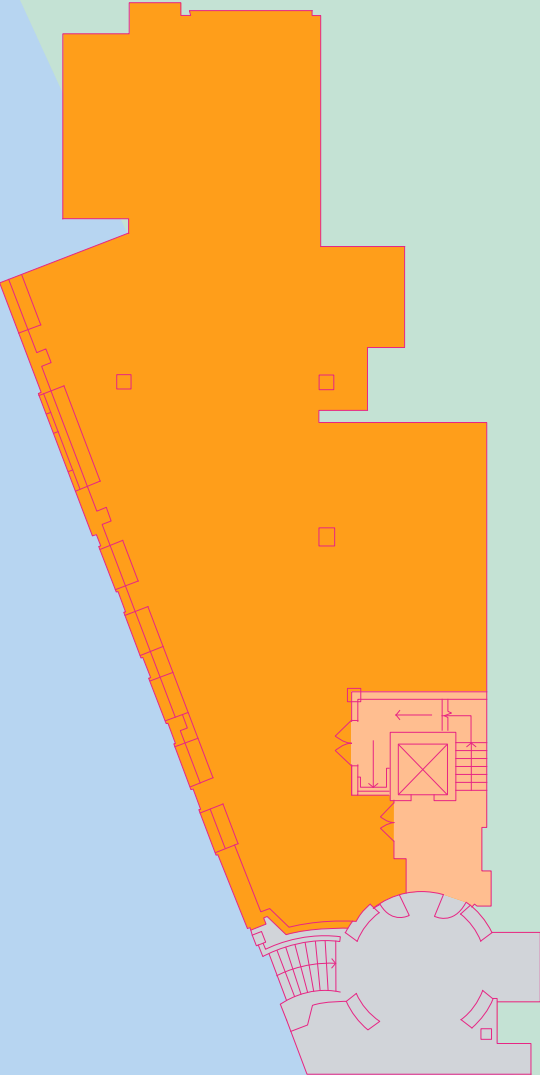

MONKWELL SQUARE

1ST FLOOR

NIA
4,662 sq. ft
433 sq. m

GIA
5,408 sq. ft

- Net Internal Area
- Core

**INDICATIVE ONLY, NOT TO SCALE,
SUBJECT TO FINAL DESIGN**

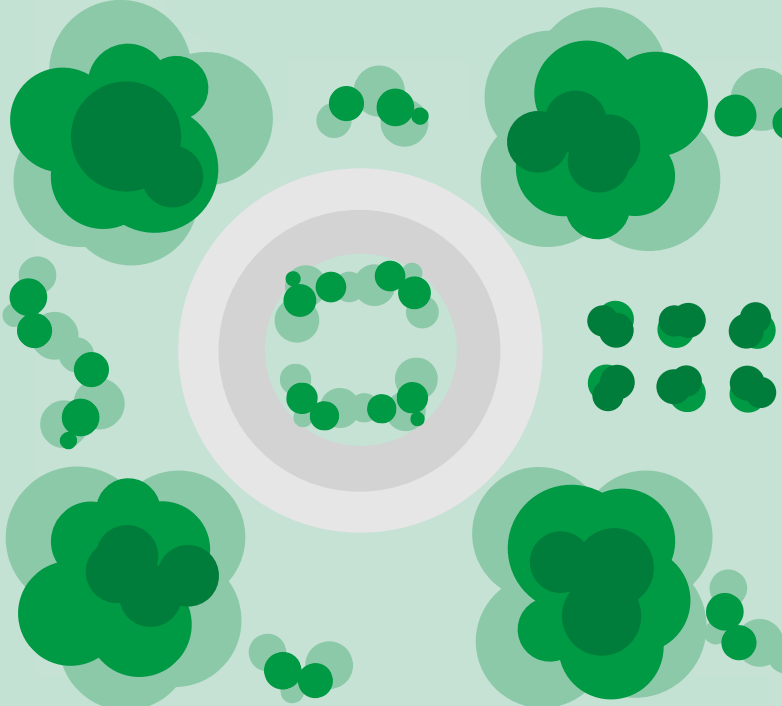
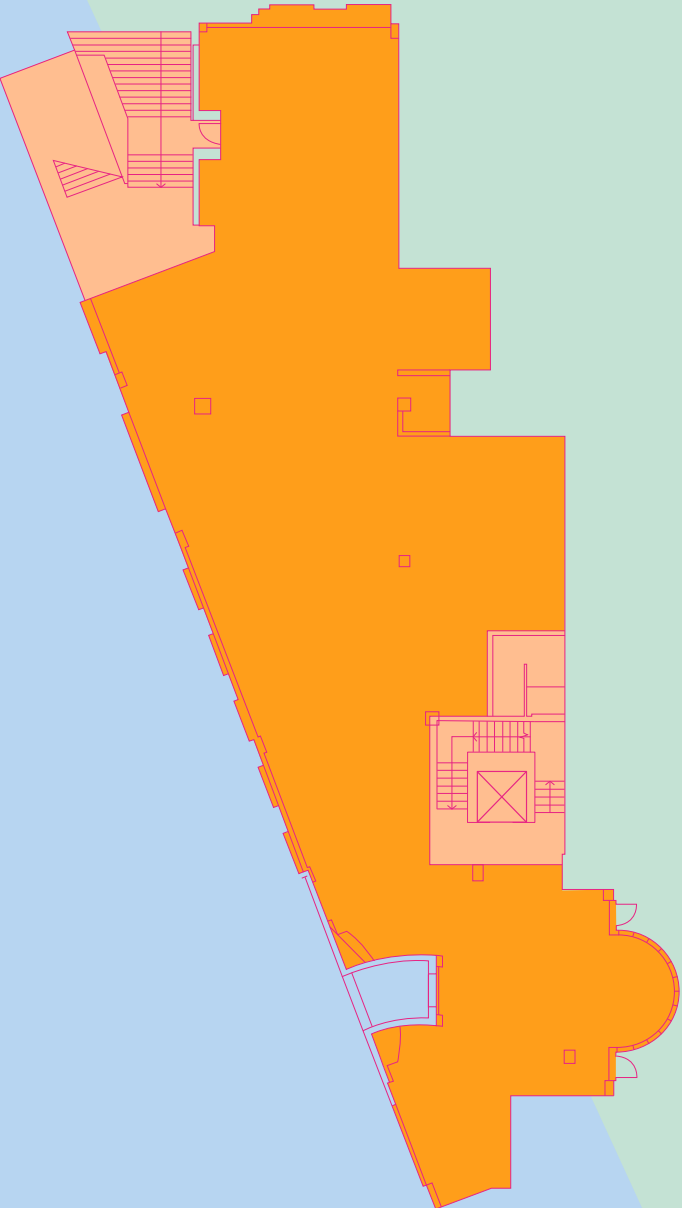

MONKWELL SQUARE



PODIUM LEVEL



- MODE Reception
- MODE Studios Amenity/Leisure
- Podium Amenity Space

INDICATIVE ONLY, NOT TO SCALE,
SUBJECT TO FINAL DESIGN

2ND FLOOR PODIUM LEVEL

NIA
4,154 sq. ft
386 sq. m

GIA
4,194 sq. ft

- Office Space
- Core
- Common Parts

INDICATIVE ONLY, NOT TO SCALE,
SUBJECT TO FINAL DESIGN

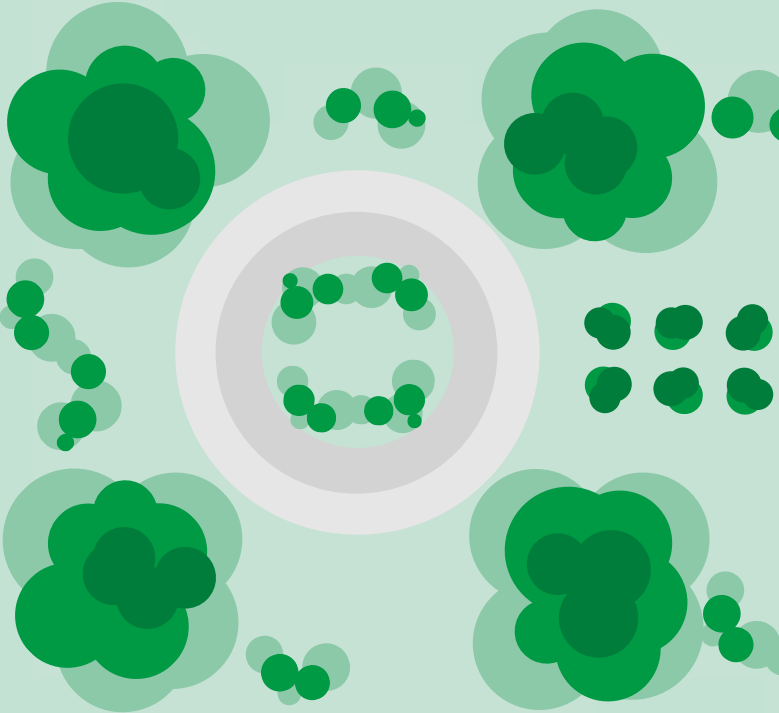
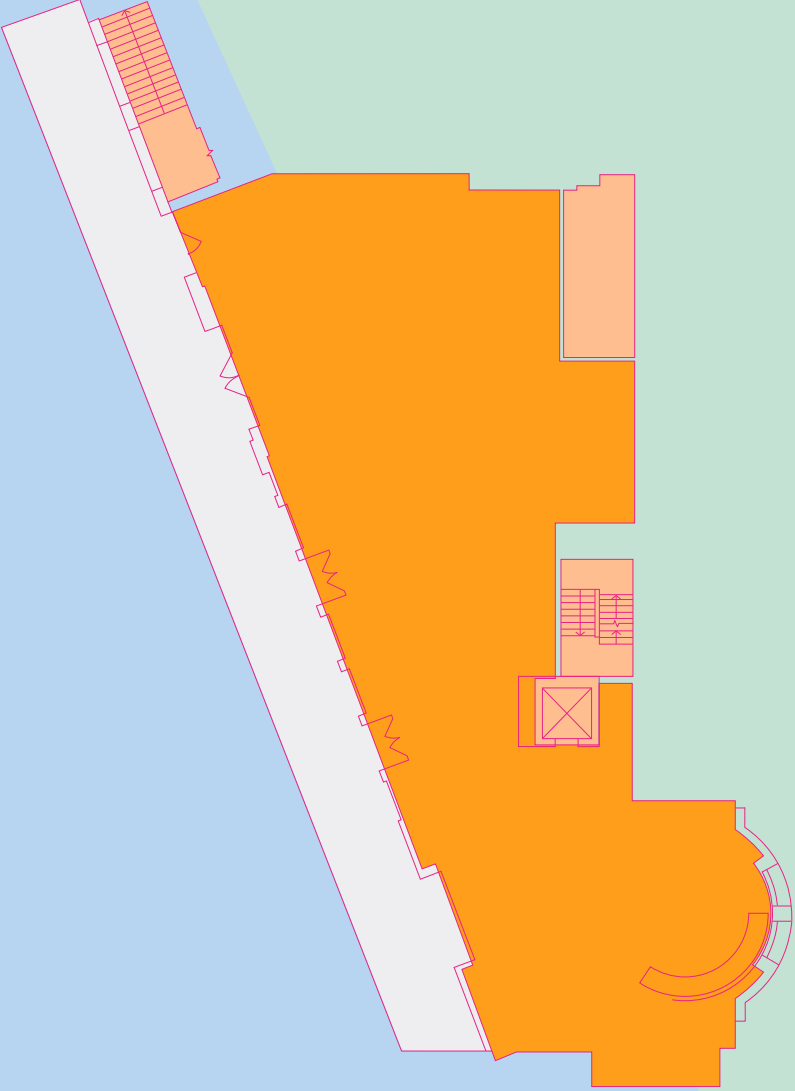

MONKWELL SQUARE

3RD FLOOR

NIA
4,682 sq. ft
435 sq. m

GIA
5,564 sq. ft

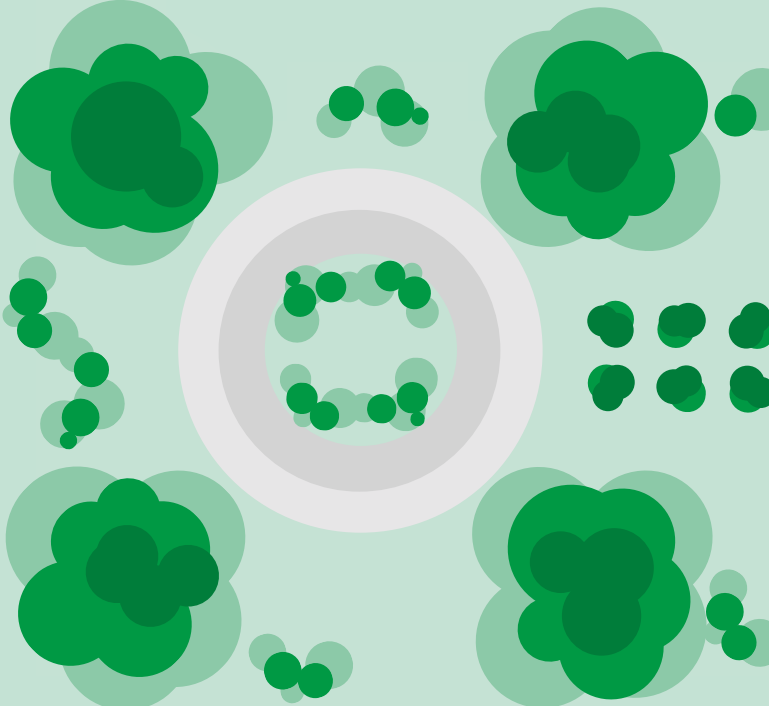
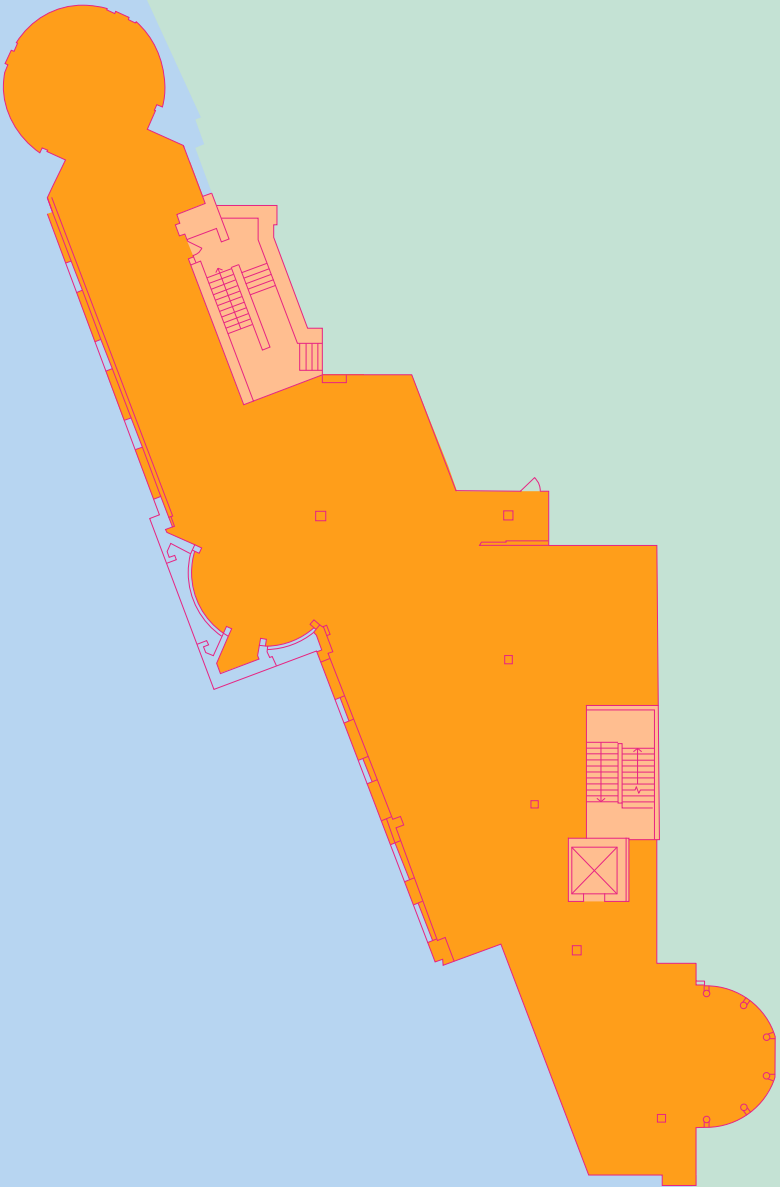

MONKWELL SQUARE

- Net Internal Area
- Core

INDICATIVE ONLY, NOT TO SCALE,
SUBJECT TO FINAL DESIGN



4TH FLOOR

NIA
4,016 sq. ft
373 sq. m

GIA
5,332 sq. ft

- Net Internal Area
- Core

INDICATIVE ONLY, NOT TO SCALE,
SUBJECT TO FINAL DESIGN

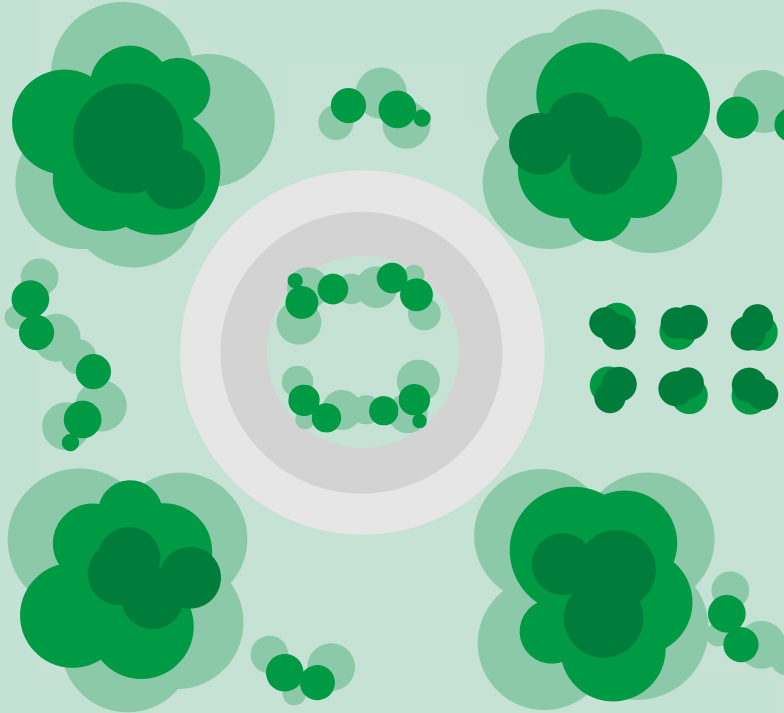
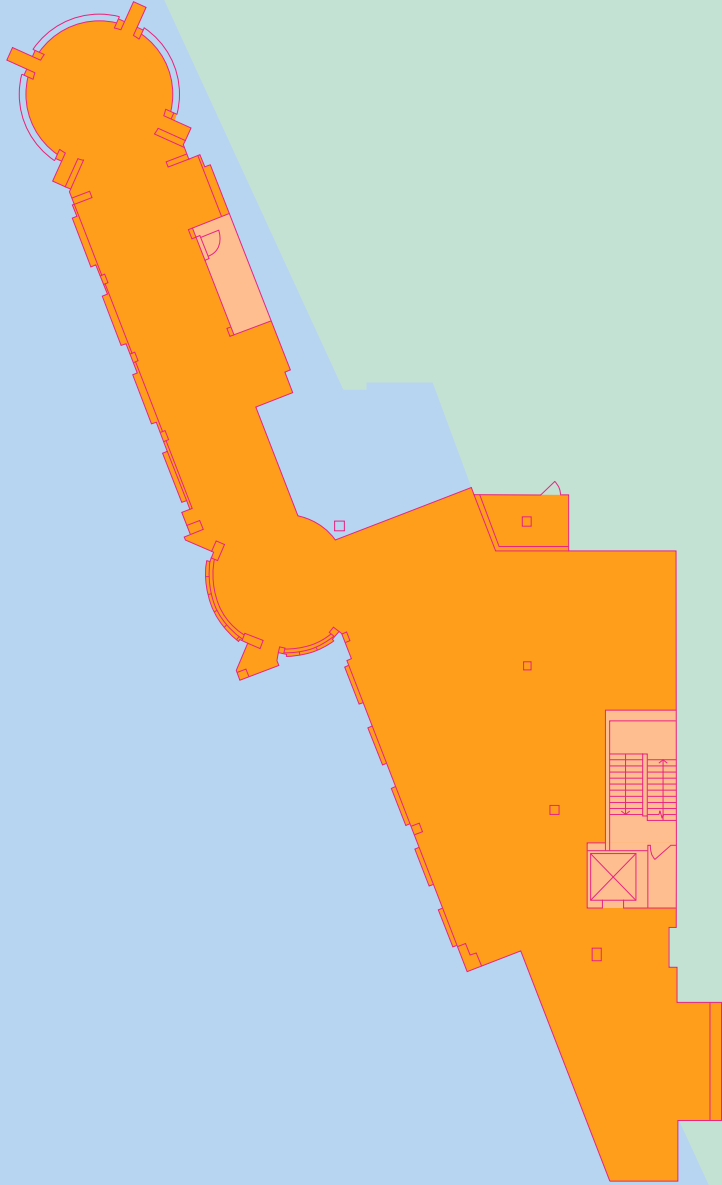

MONKWELL SQUARE

GF Floor

NIA – 3,927 sq. ft
GIA – 4,771 sq. ft

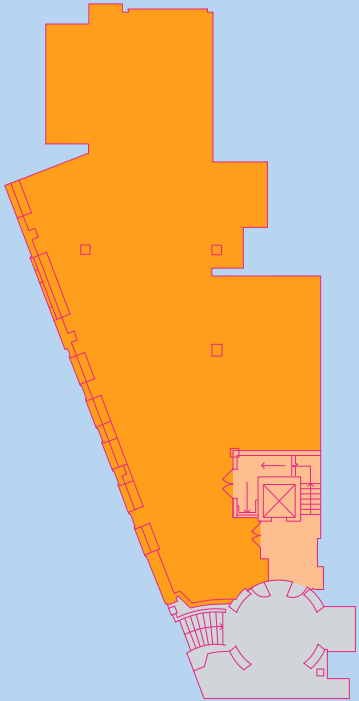

1st Floor

NIA – 4,662 sq. ft
GIA – 5,408 sq. ft

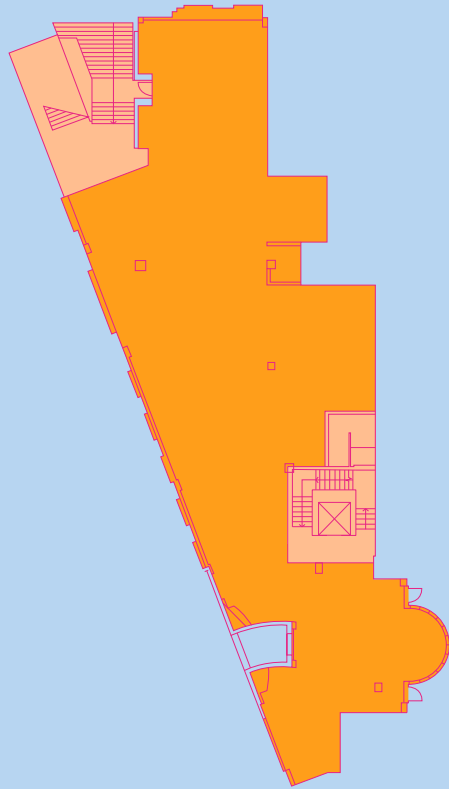

2nd Floor (Podium Level)

NIA – 4,154 sq. ft
GIA – 4,194 sq. ft

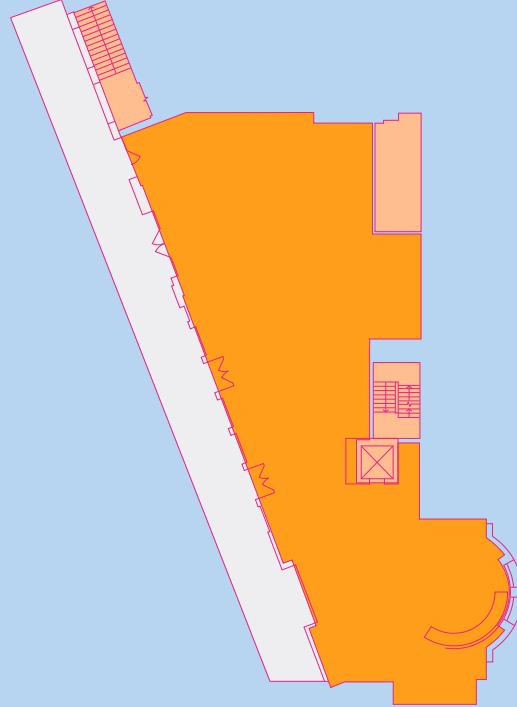

3rd Floor

NIA – 4,682 sq. ft
GIA – 5,564 sq. ft

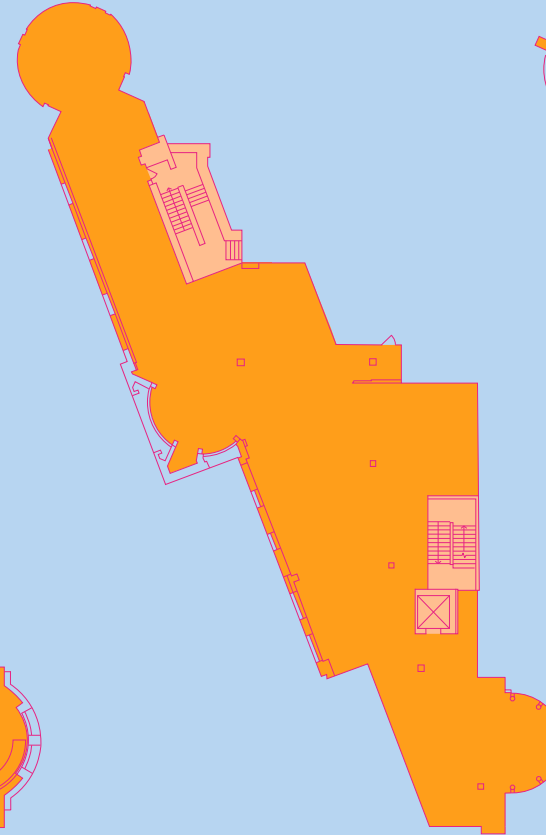

4th Floor

NIA – 4,016 sq. ft
GIA – 5,332 sq. ft

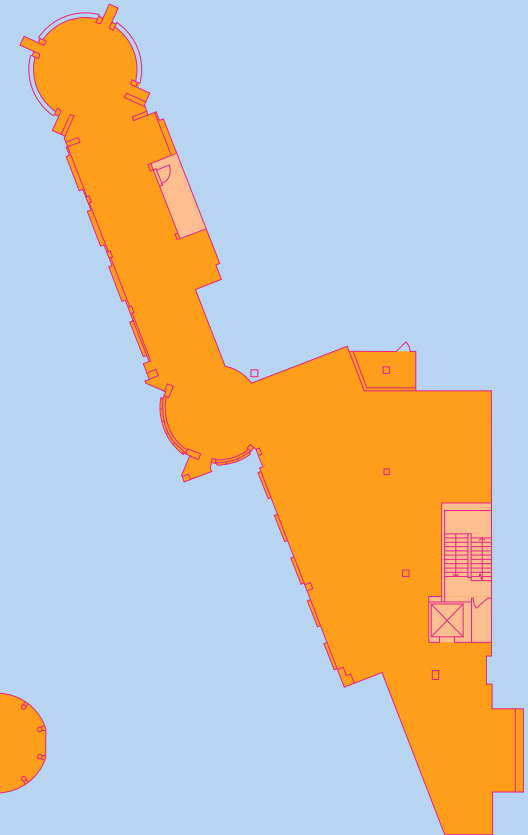

INDICATIVE ONLY, NOT TO SCALE,
SUBJECT TO FINAL DESIGN



CONTACT US

OFFICE ENQUIRIES



Tim Plumbe

tim.plumbe@cushwake.com
+44 (0)203 296 2005
+44 (0)7768 146 280

Tom Fayers

tom.fayers@cushwake.com
+44 (0)20 3296 4226
+44 (0)7973 821 247



Dan Gaunt

dan.gaunt@knightfrank.com
+44 (0)207 861 1314
+44 (0)7818 008 981

Mike Voller

mike.voller@knightfrank.com
+44 (0)207 861 1318
+44 (0)7739 763 699



Jeremy Attfield

jeremy.attfield@jll.com
+44 (0)207 399 5675
+44 (0)7703 234 261

Rory Paton

rory.paton@jll.com
+44 (0)207 852 4381
+44 (0)7900 245 221

RETAIL & LEISURE ENQUIRIES



Alex Lowry

alex@cfcommercial.co.uk
+44 (0)203 370 4333
+44 (0)7801 966 825

Important notice relating to the Misrepresentation Act 1967 and the Property Misdescriptions Act 1991: (i) the particulars are set out as a general outline only for guidance of intending purchasers or lessees and do not constitute, nor constitute part of, an offer or contract (ii) all descriptions, dimensions, references to condition and necessary permission for use and occupation, and other details are given in good faith and are believed to be correct, but any intending purchasers or occupiers should not rely on them as statements or representations of fact, but must satisfy themselves by inspection or otherwise as to the correctness of each of them. Q3 2024.

DISCOVER MORE AT [MODE-LONDON.COM](https://www.mode-london.com)